



Green Pin® Eye Nut S/S-GR5

Grade 5 stainless steel eye nut

- **Material:** AISI 316L, grade 5
- **Safety factor:** MBL equals 5 x WLL
- **Finish:** polished
- **Temperature range:** -40°C up to +200°C
- **Certification:** 2.1 2.2 3.1 MPI¹ CE



ELI

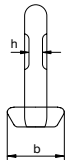
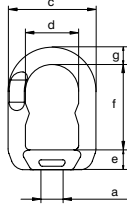

| working load limit | diameter thread | diameter base | width | width inside | thickness base | length inside | diameter | thickness | weight each |
|--------------------|-----------------|---------------|-------|--------------|----------------|---------------|----------|-----------|-------------|
| t | a mm | b mm | c mm | d mm | e mm | f mm | g mm | h mm | kg |
| 0.12 | M6 x 1.00 | 31 | 51 | 30 | 14 | 44 | 11 | 6 | 0.15 |
| 0.2 | M8 x 1.25 | 31 | 51 | 30 | 14 | 44 | 11 | 6 | 0.15 |
| 0.4 | M10 x 1.50 | 31 | 51 | 30 | 14 | 44 | 11 | 6 | 0.15 |
| 0.6 | M12 x 1.75 | 39 | 56 | 32 | 15 | 48 | 12 | 6 | 0.23 |
| 0.8 | M14 x 2.00 | 39 | 56 | 32 | 15 | 48 | 12 | 6 | 0.23 |
| 1 | M16 x 2.00 | 44 | 65 | 37 | 17 | 60 | 14 | 8 | 0.37 |
| 1.5 | M18 x 2.50 | 44 | 65 | 37 | 17 | 60 | 14 | 8 | 0.37 |
| 2 | M20 x 2.50 | 44 | 65 | 37 | 17 | 60 | 14 | 8 | 0.37 |
| 2.5 | M22 x 2.50 | 52 | 79 | 48 | 21 | 75 | 16 | 11 | 0.63 |
| 3 | M24 x 3.00 | 52 | 79 | 48 | 21 | 75 | 16 | 11 | 0.63 |
| 3.5 | M27 x 3.00 | 52 | 79 | 48 | 21 | 75 | 16 | 11 | 0.63 |



Green Pin® Weld-On Transport Ring S/S-GR5

Grade 5 stainless steel weld-on transport ring

- **Material:** AISI 316, grade 5
- **Safety factor:** MBL equals 4 x WLL
- **Finish:** polished
- **Temperature range:** -40°C up to +200°C
- **Certification:** 2.1 2.2 3.1 CE
- **Note:** regarding the selection of welding material, respecting parent and PASI materials, please refer to EN 3581 for manual metal arc welding and to EN ISO 14343 for arc welding



PASI

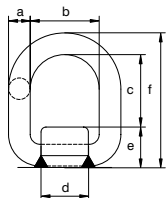

| working load limit | diameter | width inside | length inside | length base | height base | length | weight each |
|--------------------|----------|--------------|---------------|-------------|-------------|--------|-------------|
| t | a mm | b mm | c mm | d mm | e mm | f mm | kg |
| 0.75 | 13 | 40 | 42 | 35 | 28 | 83 | 0.4 |
| 1.25 | 18 | 45 | 48 | 42 | 33 | 99 | 0.8 |
| 3.2 | 22 | 55 | 57 | 49 | 42 | 121 | 1.4 |
| 5 | 26 | 70 | 67 | 64 | 50 | 143 | 2.5 |

INFO