



Green Pin® Shortening Clutch EN 1677-1 GR8

Grade 8 shortening clutch EN 1677-1

- **Material:** alloy steel, grade 8, quenched and tempered
- **Safety factor:** MBL equals 4 x WLL
- **Standard :** EN 1677-1 and DIN 5692
- **Finish:** painted yellow (J), red (R) or white
- **Temperature range:** -40°C up to +200°C
- **Certification:** 2.1 2.2 3.1 MPI[®]



GC

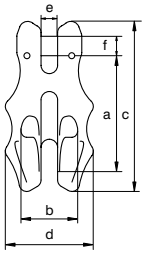

for chain diameter		working load limit	length	width inside	length	width outside	width	diameter pin	weight each
mm	inch	t	a mm	b mm	c mm	d mm	e mm	f mm	kg
6	7/32	1.12	51	23	75	42	7	8	0.22
7/8	1/4 - 5/16	2	67	30	94	50	9	9	0.41
10	3/8	3.2	79	38	116	63	12	13	0.82
13	1/2	5.4	103	49	149	79	15	16	1.67
16	5/8	8.2	128	60	184	99	19	20	3.1
18/20	3/4	12.8	154	75	215	124	23	24	4.02

INFO



Green Pin® Shortening Clutch with Lock EN 1677-1 GR8

Grade 8 shortening clutch with locking pin EN 1677-1

- **Material:** alloy steel, grade 8, quenched and tempered
- **Safety factor:** MBL equals 4 x WLL
- **Standard :** EN 1677-1 and DIN 5692
- **Finish:** painted yellow (J), red (R) or white
- **Temperature range:** -40°C up to +200°C
- **Certification:** 2.1 2.2 3.1 MPI[®]

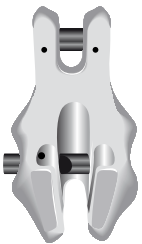

GCV

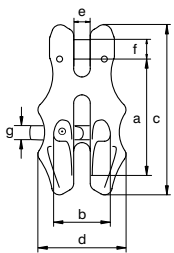

for chain diameter		working load limit	length	width inside	length	width outside	width	diameter pin	diameter pin	weight each
mm	inch	t	a mm	b mm	c mm	d mm	e mm	f mm	g mm	kg
6	7/32	1.12	51	23	75	42	7	8	7	0.22
8	1/4 - 5/16	2	67	30	94	50	9	9	8	0.41
10	3/8	3.2	79	38	116	63	12	13	12	0.82
13	1/2	5.4	103	49	149	79	15	16	16	1.67
16	5/8	8.2	128	60	184	99	19	20	20	3.1
20	3/4	12.8	154	75	215	124	23	24	20	4.02

INFO