



## Green Pin® Sling Hook E GR10

### Grade 10 eye sling hook

- **Material:** alloy steel, grade 10, quenched and tempered
- **Safety factor:** MBL equals 4 x WLL
- **Finish:** painted blue
- **Temperature range:** -40°C up to +200°C
- **Certification:** 2.1 2.2 3.1 MPI<sup>®</sup> DGVU
- **Note:** from 10 t without flat part



UCSO

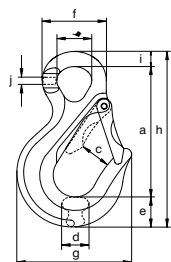

for chain diameter		working load limit	length	diameter inside eye	width opening	thickness	width	diameter eye outside	width outside	length	width	thickness	weight each
mm	inch	t	a mm	b mm	c mm	d mm	e mm	f mm	g mm	h mm	i mm	j mm	kg
6	7/32	1.4	84	23	26	15	20	43	72	114	10	6	0.28
8	9/32 - 5/16	2.6	103	26	30	20	24	51	87	139	12	8	0.52
10	3/8	4	128	35	33	24	29	65	106	172	15	10	1.09
13	1/2	6.8	152	41	37	32	39	77	133	209	18	12	1.94
16	5/8	10.3	190	52	44	40	44	94	165	255	21	16	3.51
20	3/4	16	237	60	61	49	62	115	208	327	28	21	7.1



## Green Pin® Sling Hook CL GR10

### Grade 10 clevis sling hook

- **Material:** alloy steel, grade 10, quenched and tempered
- **Safety factor:** MBL equals 4 x WLL
- **Finish:** painted blue
- **Temperature range:** -40°C up to +200°C
- **Certification:** 2.1 2.2 3.1 MPI<sup>®</sup> DGVU



UCSC

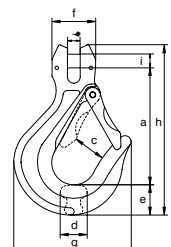

for chain diameter		working load limit	length	width	width opening	thickness	width	width outside	width outside	length outside	diameter pin	weight each
mm	inch	t	a mm	b mm	c mm	d mm	e mm	f mm	g mm	h mm	i mm	kg
6	7/32	1.4	75	7	26	15	20	28	72	108	8	0.29
	9/32	1.95	95	9	30	20	24	32	87	136	10	0.58
8	5/16	2.6	95	9	30	20	24	32	87	136	10	0.58
10	3/8	4	113	12	33	24	29	42	106	164	13	1.11
13	1/2	6.8	138	15	37	32	39	54	133	208	16	2.12
16	5/8	10.3	161	19	44	40	44	68	165	240	20	3.78
20	3/4	16	198	22	61	49	62	82	208	305	24	7.49